

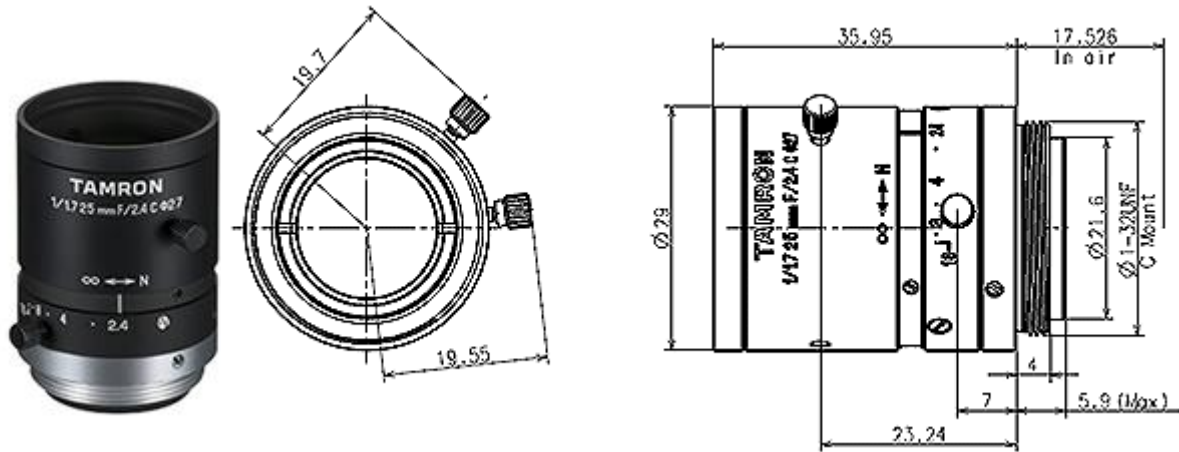

M117FM25



SPECIFICATIONS

		M117FM25
Imager Size		1/1.7
Mount Type		C
Focal Length		25mm
Aperture Range		2.4 - 16
Angle of View (Horizontal x Vertical)	1/1.7	17.4° x 13.1°
	1/1.8	17.1° x 11.5°
	1/2	14.8° x 11.2°
	1/3	11.2° x 8.4°
TV Distortion		-0.1% (Design Value)
Focusing Range		0.1m - ∞
Operation	Focus	Manual with Lock
	Iris	Manual with Lock
Filter Size		M27 P=0.5mm
Wave Length		Visible Light
Weight		45g
Operating Temperature		-20°C - +60°C