

# CMFA0420ND

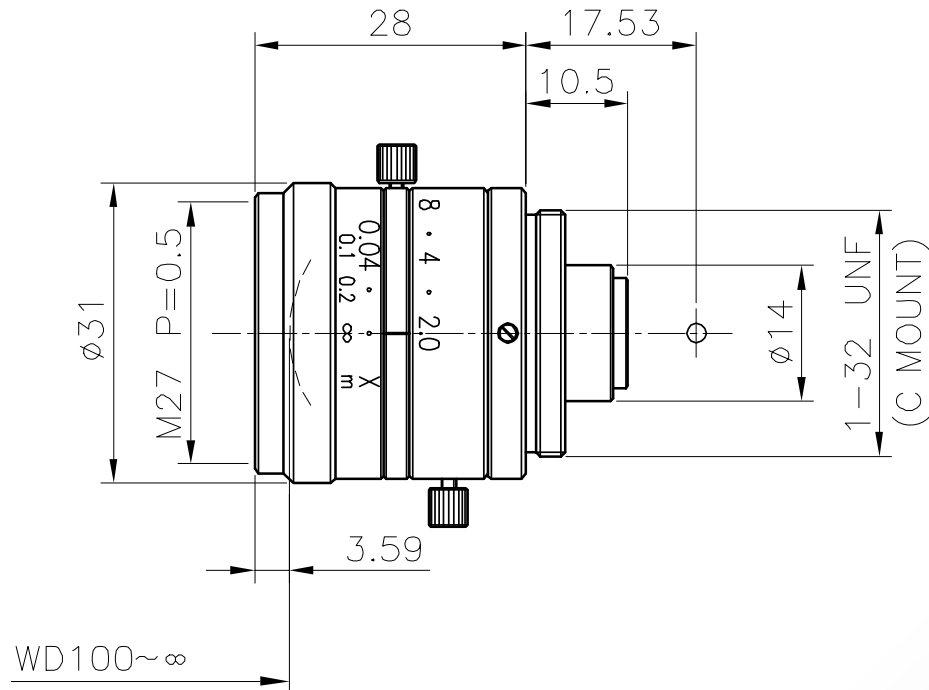

The C-Mount lens Lensagon CMFA0420ND is suitable for common sensors up to 1 megapixel with an image format of 1/2 inch. It is characterized by a particularly high light intensity.

## Technical Data

Mount	C-Mount
Sensor	1/2 inch
Focal Length	4.16 mm
Aperture	2
MOD	0.1 m
Angle of View	D:90° H:74.14° V:59.96°
Megapixel	1-2 MP
IR Correction	No
IR Cut Filter	No
TV Distortion	0.91 %
Image Circle	8 mm
Weight	56 g
Iris	manual
Focus	fixed
Filter	M27 x P0.5
Typ	Standard



Light Sensitive



1 Megapixel